

How you may find us !

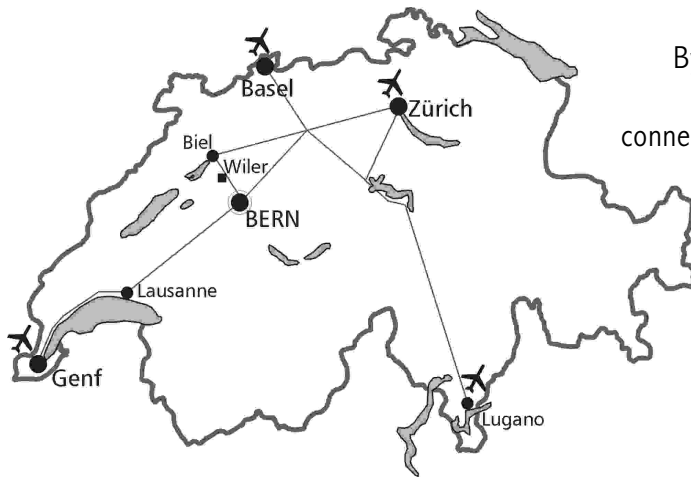

By plane you will most probably arrive either at Zürich or Geneva airport, since these have the best international connections. Of course you may also take the car or travel by train, where you would follow the main direction of Biel or Bern to get to Wiler. Wiler is more or less in the middle between Biel and Bern. If you travel by train, you should select Lyss as your final destination and call us from there. We can pick you up within 15 minutes - of course it helps to give us a notice well before you travel.

Travelling by car you have to leave the highway at the exit Lyss-Süd after which you head towards Lyss (coming from Bern this is a right hand turn, coming from Biel you go left). In Lyss you will enter the other main road right in front of the Restaurant Bären. There you turn right which means you are already on your way to leave Lyss again. At the end of the town you can take a right turn again, there you find "Wiler, Seedorf" already indicated. In Wiler you drive almost through the whole village. In the center of the village there is a rather sharp bend and about 300m after that you will see a group of houses to your right. This is where we (and for a while also you) are at home.

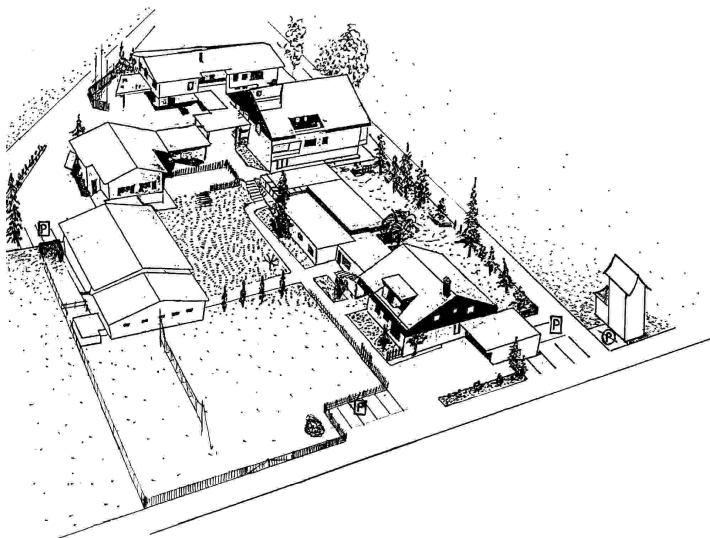
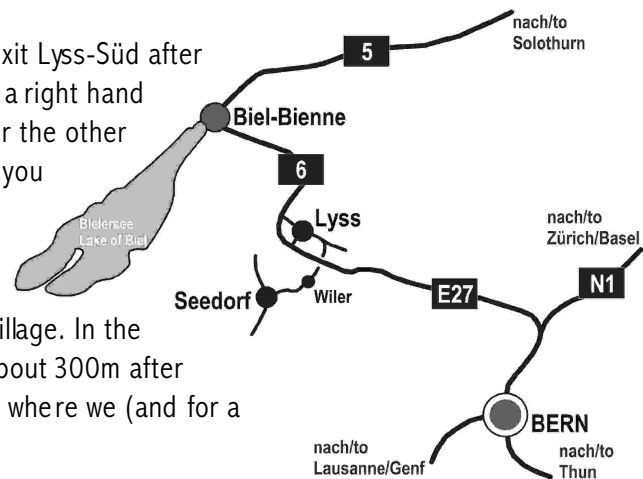

Attention:

Please do NOT try to get a train ticket right to Wiler. If you do, you will end up in another Wiler, but not the one where we are...

Get a train ticket to Lyss. Wiler is about 7 km away from Lyss. We can either pick you up in Lyss, or you may take the Post-Bus to get to Wiler.

Here on the left you see a sketch of our base.

Youth with a Mission
Hauptstrasse 15
CH 3266 Wiler
Tel: +41 (0)32 / 391 70 30
Fax: +41 (0)32 / 391 70 31